

Installation instructions : Halo Arezzo LED Cabinet Light SY7196

Thank you for purchasing this SycamoreLED.com product. Please make sure instructions are followed carefully prior to and during installation and product is not altered, otherwise warranty may not be valid. For technical support or warranty information please visit www.sycamoreLED.com, or call our dedicated technical helpline +44 (0) 113 2866686.

IMPORTANT—Please read prior to installation

- 1) Please read these instructions carefully before commencing any work
- 2) This product must be installed by a qualified electrician in accordance with the current IEE wiring regulations
- 3) To prevent electrocution switch the power off at the mains supply before installing or maintaining this fitting
- 4) Ensure others cannot restore the electrical supply without your knowledge
- 5) The PSU must be rated 12VDC and be compatible with the pre-wired connector system of this product
- 6) Never exceed the wattage stated

INSTALLATION DIAGRAMS

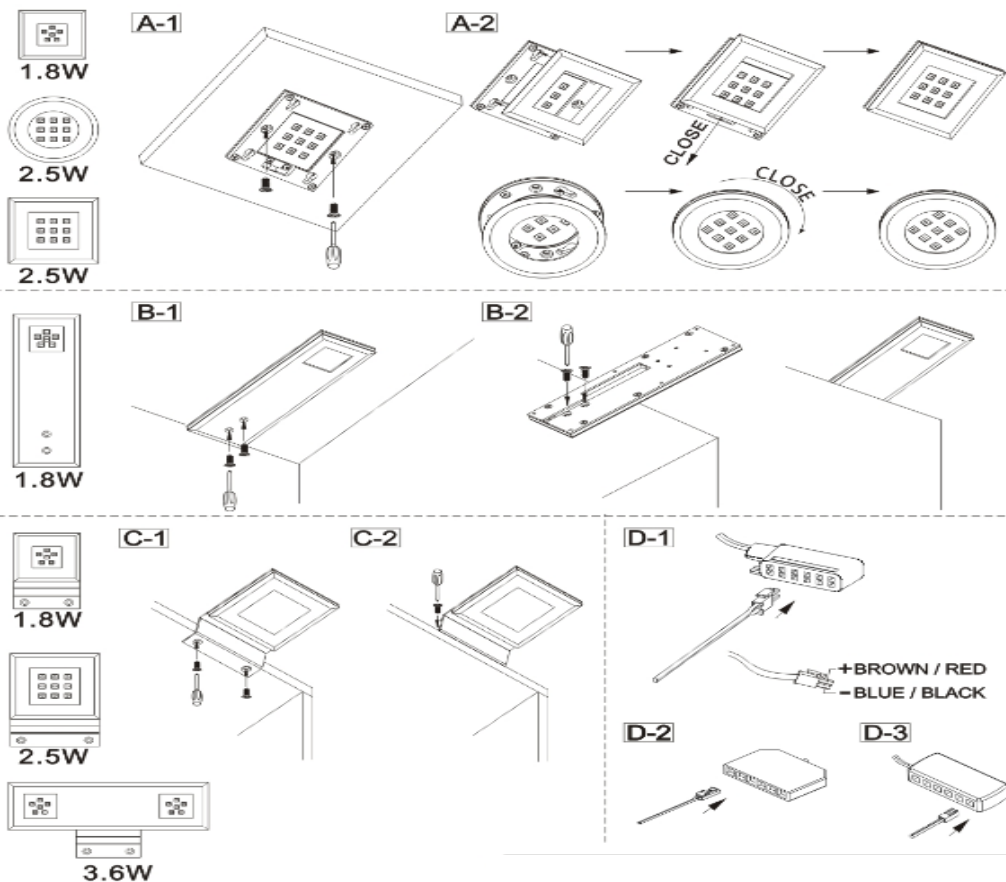

sycamore SY7196



This luminaire contains built-in LED lamps.



} LED

The lamps cannot be changed in the luminaire.

874/2012

