

SYCAMORE

Pulse Smart Receiver (WiFi + 2.4G)

Model: SY5002

Features

- Color temperature, brightness dimmable
- Biological rhythm and music rhythm
- Push dimming
- 4096 level smooth dimming, mini brightness 0.1%, dimming range 0.1%-100%
- One controller support max 12pcs remote (control distance 30m)
- Auto transmitting: transmit signal to another one automatically and expand unlimited control distance
- Auto synchronization: dynamic mode can synchronize and keep same for all devices
- Support DND mode and usually used for power failure area to save power
- Support "TUYA SMART" APP control
- Support Alexa, Google Assistant, Yandex Alice



Parameters

Product Name:	Pulse Smart Receiver
Model No.:	SY5002
Input Voltage:	DC12~48V
Output Current:	Max 10A
Output Power:	120W~480W
Output Type:	Constant Voltage
Protocol:	WiFi+2.4GHz RF
RF Remote Control Distance:	30m
IP Rate:	IP20
Working Temp.:	-10~40°C

Dimming level:	4096 levels
Dimming Range:	0.1%-100%
Dimming Curve:	Logarithmic
EMC Standard (EMC):	ETSI EN 301 489-1 V2.2.3 ETSI EN 301 489-3 V2.1.1
Safety Standard (LVD):	EN 61347-1:2015+A1:2021 EN 61347-2-11:2001+A1:2019
Radio Equipment (RED):	ETSI EN 300 440 V2.2.1
Certification:	CE, EMC, LVD, RED
Warranty:	5 Years

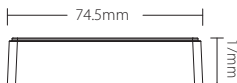
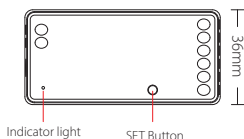

Connection Diagram

Input: DC12V~48V

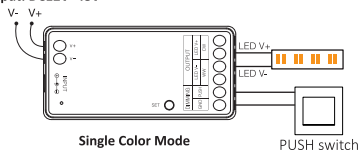

Input: DC12V~48V

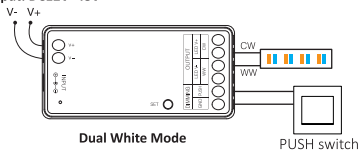

Application Diagram

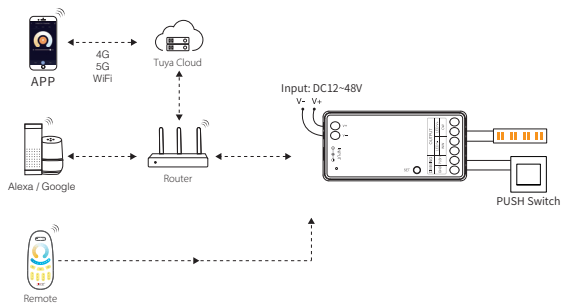

PUSH Switch Dimming

Short press the "PUSH switch"

Turn lights on or off.

Long press the "PUSH switch"

Adjust the light brightness level.

Set up output mode

Set up correct output mode based on the feature of lights

Setting method: Press "SET" button continuously to switch output mode (attention: it will log out without operation within 3 seconds)

Output mode sheet (confirm output mode based on color of indicator)

Indicator color	Red Light	Green Light
Output	Single Color Mode	Dual White Mode

Compatible with these 2.4G RF remote controls (Purchased separately)



SY9565A



SY9565



SY8813



SY8817



SY8810DIM



SY8810TUNABLE



SY8818

2.4G RF Remote control instruction

Linking Code Instructions

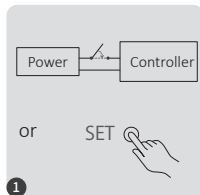

Power off 10 seconds and power on again or short press " SET " one time

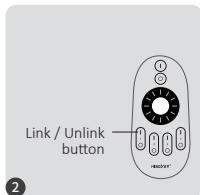

Short press " 1 " button 3 times within 3 seconds.

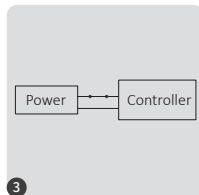

Lights blink 3 times slowly means linking is done successfully.



Linking failed if light is not blinking slowly, Please follow above steps again.
(Note: Light that have linked can't link again)

Unlinking Code Instructions

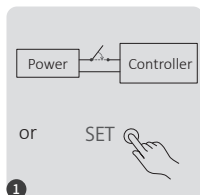

Power off 10 seconds and power on again or short press " SET " one time

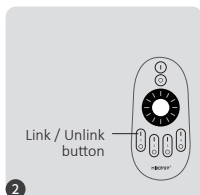

Short press " 1 " button 5 times within 3 seconds.

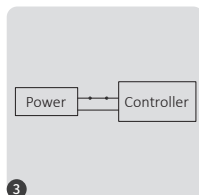

Lights blink 10 times quickly means unlinking is done successfully.



Unlinking failed if light is not blinking quickly, Please follow above steps again.
(Note: Light haven't linked that don't need to unlink)

Auto transmitting

Remote signal auto transmitting

One light can transmit the signals from the remote control to another light within 30m, as long as there is a light within 30m, the remote control distance can be limitless.

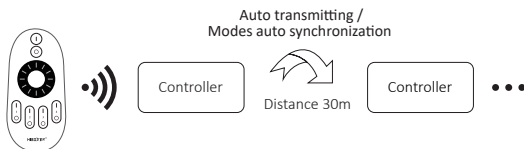

“Do Not Disturb” mode is activated and shut down (default activated)

Turn on “Do Not Disturb” mode (wide using in the area which have power failure frequently to save energy)

2.4G RF Remote turn on and turn off instruction

Turn on “Do Not Disturb” mode:

Press “OFF” button three times within three seconds and press “ON” button three times, Activated successfully once led light flashes four times quickly.

Attention: Do not disturb mode is activated

1. When the light is OFF status (For example: Use app or remote to turn off light)

The light is OFF status once you turn off power and turn on again.

(User must turn off and turn on power twice times to activate light or use APP / remote to activate light)

2. When the light is ON status

The light is ON status once you turn off and turn on power one time.

Turn off “Do Not Disturb” mode:

Press “ON” button three times within three seconds and press “OFF” button three times, closed successfully once led light flashes four times slowly.

Attention: The light will be always “ON” status if you turn on and turn off power once user closed “Do Not Disturb” mode.

App turn on and off “Do Not Disturb” mode instruction

(Check point 3 of the App control manual for details)

Smartphone APP control instruction

Network Configuration (Don't support 5G router)

1. Download and install [Tuya Smart] app

Search for [Tuya Smart] in Apple or Google store or scan following QR code to download and install the app.

Please open the app click "Register" button to create account while using it in the first time, Log in directly if you already had account.



2. Network Configuration

- (1) Connect controller with power supply.
- (2) Confirm indicator light is flashing quickly (2 flashes per second),
If indicator light isn't in fast flashing state, there are two ways to enter:
 - Long press "SET" key until indicator light flashing quickly.
 - Power off and on controller 6 times.
- (3) Connect phone with home WiFi network in the 2.4GHz frequency.
- (4) Open homepage of app and click "+" button at the upper right corner of page.
- (5) Click "Lighting" on the left side of page and then click "Light Source (BLE+Wi-Fi)"
- (6) Follow app prompts to complete configuration.

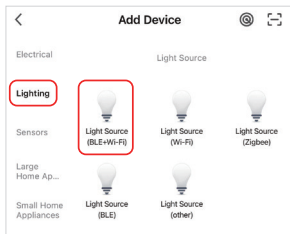
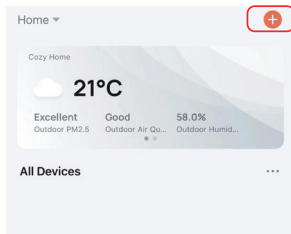

App turn on and off “Do Not Disturb” mode (default activated)

Click the light which need to be set up or group control --- click “More” --- click “Power-on behavior” --- turn on or off

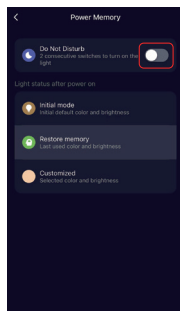
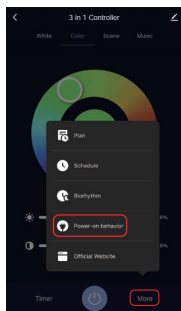
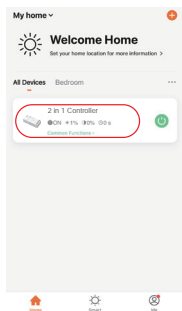

Alexa voice control instruction

Please add device into [Tuya Smart] app, then start following steps

- 1). Open Alexa App
- 2). Click "More" on the bottom of right corner
- 3). Click "Skills & Games"

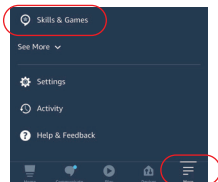

- 4). Click "Q" on the top of right corner
- 5). Type into "Smart life" and search



- 6). Click "Smart Life" skill, follow instruction to finish configuration and start voice control

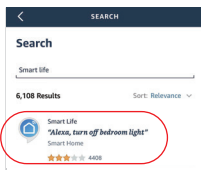

Google Home voice control instruction

Please add device into **[Tuya Smart]** app , then start following steps

- 1). Open Google Home App
- 2). Click “+” on the top of left corner

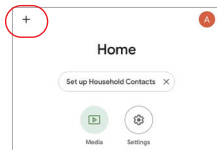

- 3). Click “Set up device”

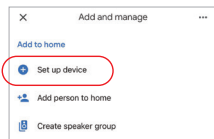

- 4). Click “Works with Google”

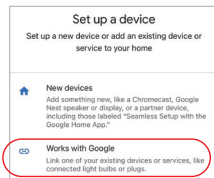

- 5). Click “Q” on the top of right corner
- 6). Type into “Smart life” and search
- 7). Click “Smart Life” skill, follow instruction to finish configuration and start voice control

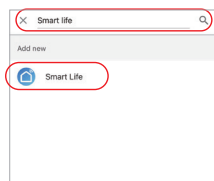

Attention

1. Please turn off power supply before installation.
2. Please ensure input voltage to be same as requirements from device.
3. Don't disassemble device if you are not expert, otherwise it will damage it.
4. Please do not use the light in the place with widely range metal area or strong electromagnetic wave nearby, otherwise, the remote distance will be seriously affected.

SYCAMORE

Sycamore Lighting Ltd
Unit 5A Helios 47, 3 Isabella Road
Garforth, Leeds, LS25 2DY, UK
0113 2866686
www.sycamoreled.com



Made in China