

Installation instructions : Multi-function Lithium Battery Dual Purpose Sensor Light SY8979

Thank you for purchasing this SycamoreLED.com product. Please make sure instructions are followed carefully prior to and during installation and product is not altered, otherwise warranty may not be valid. For technical support or warranty information please visit www.sycamoreLED.com, or call our dedicated technical helpline +44 (0) 113 2866686.

IMPORTANT—Please read prior to installation

- 1) Please read these instructions carefully before commencing any work
- 2) It is strongly recommended that this unit is installed by a qualified electrician
- 3) This product is suitable for dry places
- 4) Please ensure that the infrared sensor is uncovered
- 5) Please use dry, clean and soft cloth to maintain the product

ACCESSORIES

1 Cabinet door lighting SY8979

Size: L200*W39*H11mm

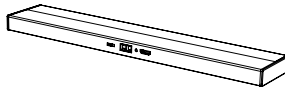

2 USB charging cable 3 Magnetic Pads

Size: 50cm



FUNCTIONALITY

Charging status indicator: Red means charging status, Green means full charged.

A: Auto Mode
O: Light off
M: Swipe (Manual) Mode

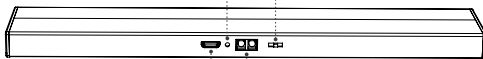

USB Charging port

Infrared transceiver

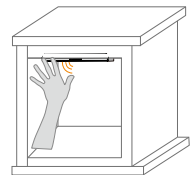

Swipe (M)

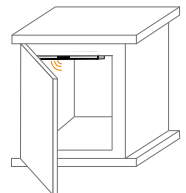

Auto (A)

Factory default setting is OFF mode; Three control switches of operating states: A, M and OFF. "A" - Auto mode: open door to illuminate light - close door for light to turn off "M" - Swipe mode: Swipe to turn light on and swipe to turn off - "O" - To turn off light

N.B. This fitting can either be used as either a door or swipe on/off sensor

INSTALLATION GUIDE

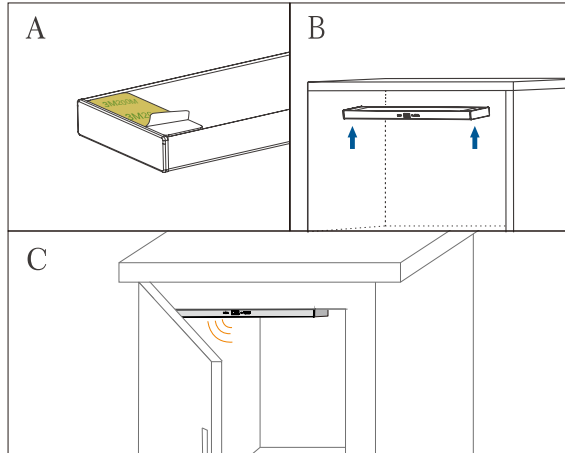

- 1) Peel off sticker (as shown in image A)
- 2) Put the two pieces of magnet on two ends of the lamp and stick on cabinet as you require (as shown in image B)
- 3) Open/close door (as shown in image C) or swipe on/off to test sensor



Notice: Please make sure the infrared sensor is uncovered.